

DIFFERENTIAL ASSEMBLY

B3E051527100103

1. Assemble in the order indicated in the table.

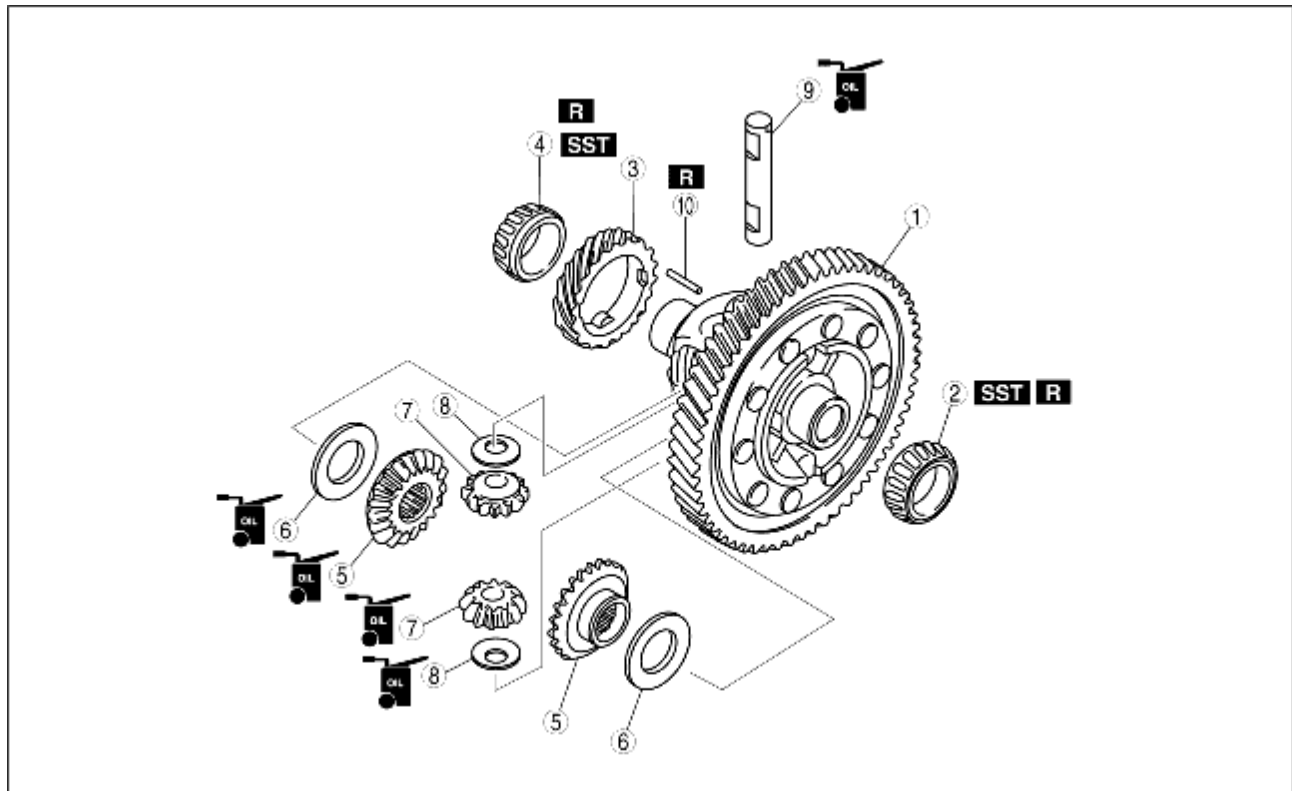

ADA5113M047

1	Ring gear and gear case component
2	Bearing (ring gear side) (See Bearing (Ring Gear Side) Assembly Note.)
3	Speedometer drive gear (See Speedometer Drive Gear Assembly Note.)
4	Bearing (side opposite ring gear) (See Bearing (Side Opposite Ring Gear) Assembly Note.)
5	Side gear
6	Thrust washer
7	Pinion gear
8	Thrust washer
9	Pinion shaft
10	Roll pin (See Roll Pin Assembly Note.)

Bearing (Ring Gear Side) Assembly Note

1. Install the new bearing using the **SSTs**.

Speedometer Drive Gear Assembly Note

1. Install the speedometer drive gear as shown in the figure.

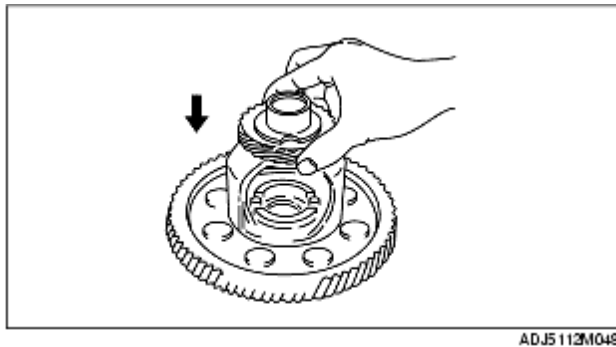

Bearing (Side Opposite Ring Gear) Assembly Note

1. Install the speedometer drive gear.
2. Install the new bearing using the SSTs.

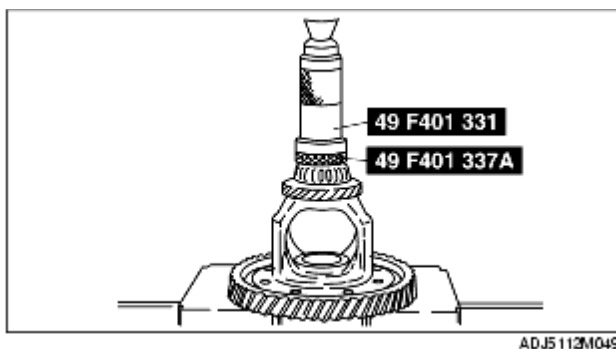

Roll Pin Assembly Note

1. Install the new roll pin as shown in the figure to hold the pinion shaft.

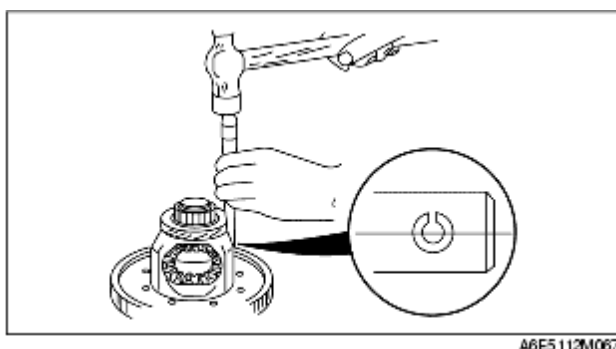

2. Measure the backlash by the following procedure.

- (1) Install the left and right drive shafts in the differential component.
- (2) Support the drive shaft on V-blocks as shown in the figure.
- (3) Measure the backlash of both pinion gears.



- If not within the specification, adjust by selecting and installing thrust washers between the case and the side gears.

Backlash**0-0.1 mm {0-0.004 in}****Caution**

- Use thrust washers with the same thickness on each side.

Thrust washer thickness

mm {in}

2.0 {0.079}	2.1 {0.083}	2.2 {0.087}
-------------	-------------	-------------

- If it exceeds the specification even when a **2.2 mm {0.087 in}** thick thrust washer is used, replace the differential component.